



PINNACLE 600

HIGH PERFORMANCE CURTAINWALL



CONTEMPORARY AND PROPORTIONATE;
THE PINNACLE CURTAINWALL IS A HIGHLY
EVOLVED STATEMENT FOR YOUR NEXT PROJECT

Architecturally Evolutionary

Pinnacle focuses on scale and weight but the statement remains yours. Pinnacle's 2.5" [63.5mm] profile is modern and embracing, it's purposeful weighting helps define and deliver a project's intended contextuality. In-house extrusions and finishes allow you to create and refine your project's vision.

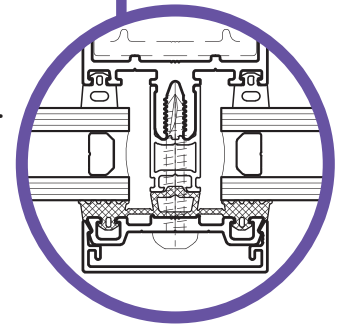

Versatility that's Transformative

The Pinnacle curtain wall solution is a carefully engineered solution that allows near limitless versatility and customization. Its various options and our in-house capabilities allow designers the opportunity to capture their project's full intent, whether for a monumental or iconic project, a retro-fitted building facade or a practical implementation, Pinnacle is a well-suited, evolved solution.



REMARKABLE VERSATILITY

Multiple mullion depths from 1" [25mm] to 7" [178mm] for various project applications, glazing opportunities and spans. Ability to address corner and splayed applications.

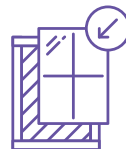

SIMPLIFIED INSTALLATION

Multipurpose components and fewer components result in simplified installation, saving time and budgets during the construction phase.



SUPERIOR GLAZING

Independent glazing chairs allow further opportunities to broaden glazing spans and allow for the implementation of larger insulated glass units.



EXCEPTIONAL THERMAL PERFORMANCE

Intelligent fully pressure-equalized design that incorporates polyamide thermal breaks and EPDM rubber gaskets allow Pinnacle to surpass all water and air infiltration standards.



PINNACLE 600

HIGH PERFORMANCE CURTAINWALL

Evolved: A High Performance Curtainwall System for Today's Most Sophisticated Projects

A multitude of features to **assist your project's vision:**

Pinnacle was designed to optimize and assist a building's overall energy performance. Pinnacle delivers industry leading thermal performance while also providing an opportunity for designers to create a project that meets their design vision. Multiple mullion depths allow for various applications and greater glazing spans. Ability for corner or splayed applications. In-house extrusions, a variety of gaskets and exterior caps including 4" [102mm] and 5" [127mm] bull nose caps, as well as in-house anodizing and near limitless custom colour matching opportunities allow you to create and deliver the project you envision.

Stick built, shear block or screw-spline design for simplified assembly and field installation

Accommodates captured, two-sided or four-sided structural silicone glazing

2.5" profile comprised of 6063 alloy; T6 or T5 temper aluminum extrusions



Industry standard and custom caps available

Extruded EPDM or silicone air and weather seal gaskets

Full frame polyamide thermal break for industry leading thermal and structural performance

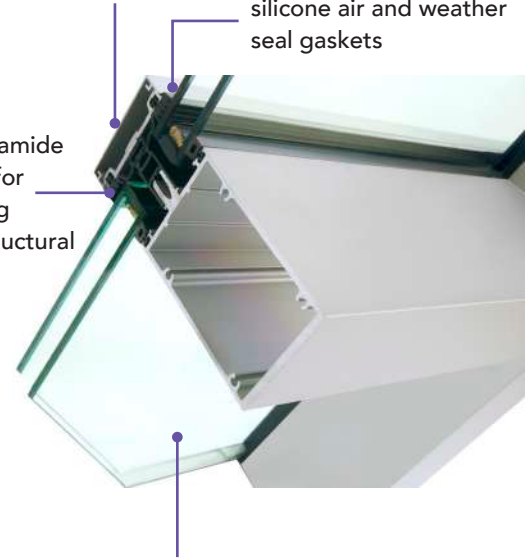

Accommodates single, double, and triple glazing

PERFORMANCE TEST STANDARDS

Air Infiltration 300 Pa (6.27 psf)	ASTM E283
Air Exfiltration 300 Pa (6.27 psf)	ASTM E283
Static Water Penetration	ASTM E331
Static Air Pressure Difference	ASTM E330
Dynamic Pressure	AAMA 501.1
Static Testing, Interstory Drift	AAMA 501.4
Dynamic Test, Seismic Drift	AAMA 501.6
Static Test, Vertical Inter-Story Movements	AAMA 501.7
Thermal Cycling of Exterior Walls	AAMA 501.5
Condensation Resistance and Thermal Modeling	NFRC 100, NFRC 200, NFRC 300, NFRC 500
All Testing for Pinnacle in Accordance with:	AAMA/WDMA/CSA 101/I.S.2/A440-11 CSA A440S1-17

THERMAL SIMULATION

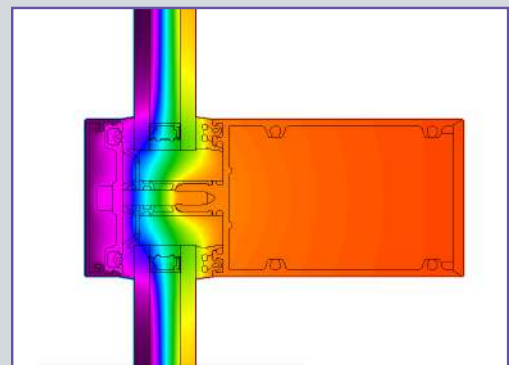

Thermal simulation of Pinnacle 600 with double glazing

For information on this visionary curtain wall

Visit apexfacades.com or call 1.866.970.5948

©10.25.2018

